

**Acme Sanitary Ware Co Ltd**



Acme Building, 22-28 Nanking Street, Kowloon, Hong Kong
 Tel: 2388 7171 Fax: 2710 8012
 E-mail: acme@acmesanitary.com.hk
 Website: www.acmesanitaryware.com.hk



For Precious Life

PROJECT		REF		REV	ITEM CODE	
LOCATION		DATE			PAGE	

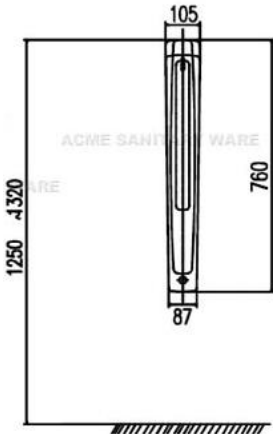
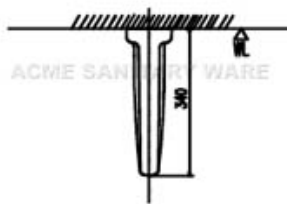
SANITARY WARE SPECIFICATION SHEET

Item Descriptions	Inax (Japan) Vitreous china urinal partition	Illustration/ Drawing						
Dimensions	W340 x D105 x H760mm	   						
Model	P1/BW1							
Finish	Vitreous China							
Brand	Inax (Japan)							
Country of Origin	Vietnam							
Source	Acme Sanitary Ware Co. Ltd Mr. Eric Wong/ Mr. Don Yuen							
Contact Tel/Fax	(852) 2388-7171 / (852) 2710-8012							
E-mail	acme@acmesanitary.com.hk							
Website	www.acmesanitary.com.hk							
<div>Specifications</div> <table><tr><td>Product name</td><td>Uniral wall-hung partition for male toilet</td></tr><tr><td>Product code</td><td>P-1</td></tr><tr><td>Specification</td><td>- Porcelain partition - To sepearate unirals in male toilet. Ensure privacy and comfort</td></tr></table>		Product name	Uniral wall-hung partition for male toilet	Product code	P-1	Specification	- Porcelain partition - To sepearate unirals in male toilet. Ensure privacy and comfort	
Product name	Uniral wall-hung partition for male toilet							
Product code	P-1							
Specification	- Porcelain partition - To sepearate unirals in male toilet. Ensure privacy and comfort							

Note:

* All information of the above is for the reference only. No prior notice is made if any changes.



Acme Sanitary Ware Co Ltd

Acme Building, 22-28 Nanking Street, Kowloon, Hong Kong

Tel: 2388 7171 Fax: 2710 8012

E-mail: acme@acmesanitary.com.hk

Website: www.acmesanitaryware.com.hk



For Precious Life

PROJECT		REF		REV	ITEM CODE	
LOCATION		DATE			PAGE	

SANITARY WARE SPECIFICATION SHEET

Installation method

1 Locating the partition

Locate the partition so as to suit the standard installation layout.

Note:

+ Customers are required to keep this instruction for future reference.

2 Mounting the partition's wall hanger

1. Temporarily mounting the wall hanger to the wall, for dimensions refer to the layout.

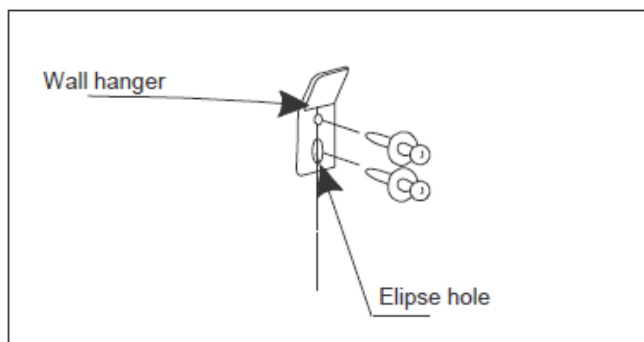

Notes:

- Keep the wall hanger straight.
 - In case of concrete wall, please be self-equipped with resin plugs
2. Hanging the partition onto the wall hanger.

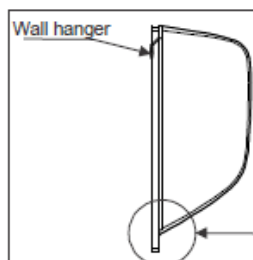

3. Installing the mounting screw to fix the partition:

1. Positioning the drilling hole, then install the resin plug and mounting screw.

Use an acorn nut to cover the screw

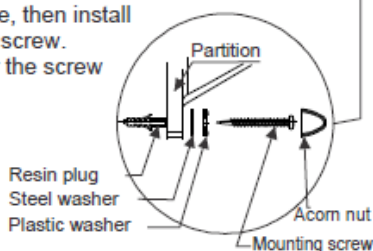

Notes:

- + Tighten the screws equally both up and down positions
- + Do not over tighten as it may break the partition

Layout drawing

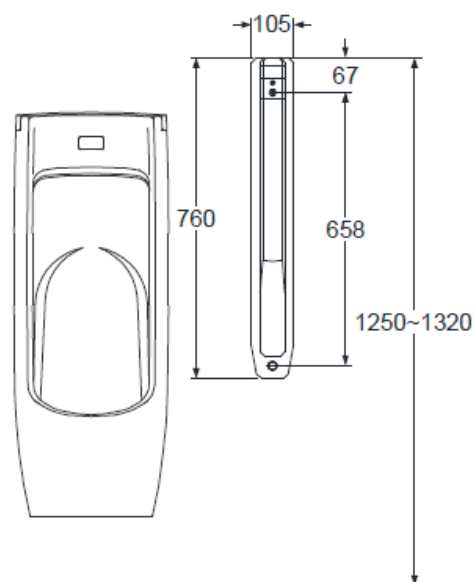

Product kit

TT	Description	Product code	Qty
1	Partition	P-1	01
2	Mounting screw	KF-30DV(P1)	01
3	Wall hanger	A-U116V-1(P1)	01

Cleaning and care

Please take notice when cleaning the product

- Use toilet cleaners specialized for porcelain products in conjunction with a soft toilet brush (do not use hard brush or rough paper). Risk of scratches can be caused.
- Mop brushed area with water and use cloth to wipe out the surface carefully.

Safety cautions

- Before installation, please check the product again for cracks or breaks during delivery
- Any cracks may cause injury, damage, break or dirty to floor.
- Do not over tighten bolts. Porcelain is subject to cracking, which may cause injury to installing person or users.
- Be sure to test operation after installation has been completed.
- Keep this instruction for future reference, as it contains important information.

Note:

* All information of the above is for the reference only. No prior notice is made if any changes.